



SNOW BRACKET H - APEX

DESCRIPTION

- Installed using (2) #14 screws that must penetrate through the roofing material and sheathing
- Designed for almost all roof types
- Can be powder coated to match roofing material color
- Overall dimensions: 5.588" L X 2 1/4" W X 3" H

MATERIALS

- Zinc Coated Steel: 16 ga (ASTM A653)
- Copper: 48 oz (ASTM B152)
- Stainless Steel: 16 ga (ASTM A240)

COLORS/FINISHES

- Zinc Plated
- Powder coating available in many colors visit <http://trasnowandsun.com/color-chart/> to see color chart

NOTE: Due to specific job conditions, TRA Snow and Sun will only warranty a snow retention system/layout that has been designed by TRA Snow and Sun.



FOR NEW CONSTRUCTION OR RETROFIT

USED ON: ALMOST ALL ROOF TYPES

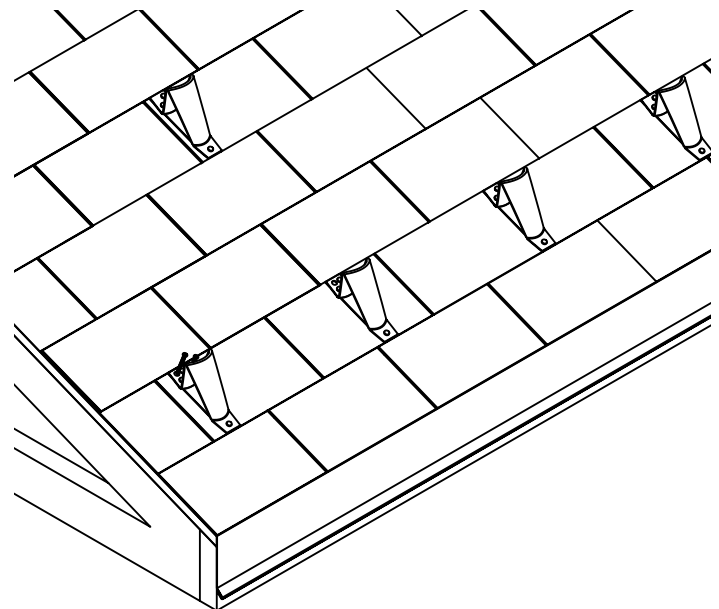
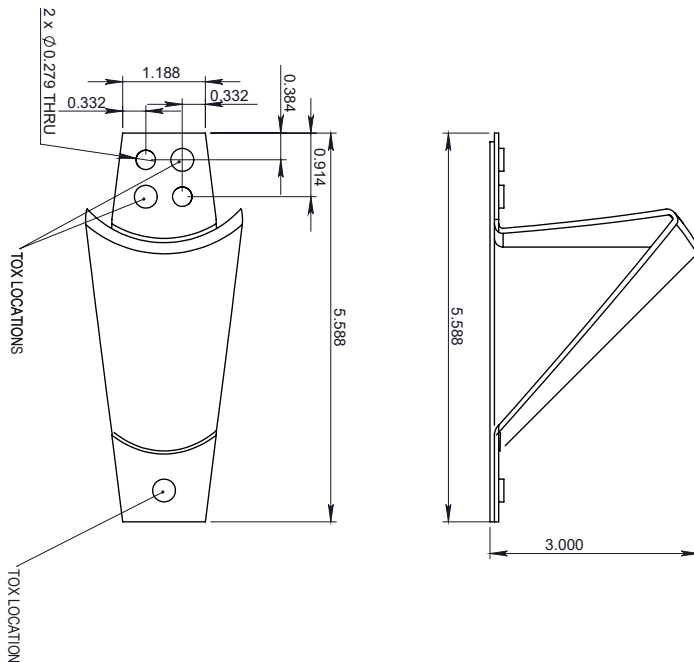

INSTALLATION:

Bracket is installed with (2) #14 screws fastened through roofing material and sheathing below. Bracket installed with triangle portion of bracket downslope of roofing material.

DIMENSIONS
DO NOT SCALE